



SHOWER CUBICLE RANGE

SHOWER CUBICLES

Shower cubicles are semi-permanent units fitted with a roof, which are free-standing. Shower cubicles are self contained and therefore no tiling is required. Normally installed within 1-2 days, no floor excavation (other than to connect gravity waste versions) is required and a ramp is provided. Removable for recycling.

All cubicles are shower chair compatible and are available with gravity or pumped waste.



100MK2 shown

Shower cubicles

- Shower chair accessible Front Entry models
- Gravity or pumped waste options
- Provided with ramp (cubicle can be recessed into floor as per photo)
- Shower Toilet model available - combines a toileting facility with a shower (includes toilet and hand basin)
- Grab rails fitted as standard
- Trifold and single alcove door options
- Shower seat options (not applicable for toilet cubicles)
- Light/extractor fan option
- Half height side panel option
- Optional macerator



100MK2 Toilet Cubicle shown



Three models are available, all are shower chair accessible, see page 9 for full accessibility options.

CUBICLE SEATS

Shower Cubicle Seats - Information for ordering

Chiltern Invadex produce a wide range of seats for use with the Shower Cubicle range. Basic size information is shown below. Specialist seats can be made to order (extended delivery times apply).

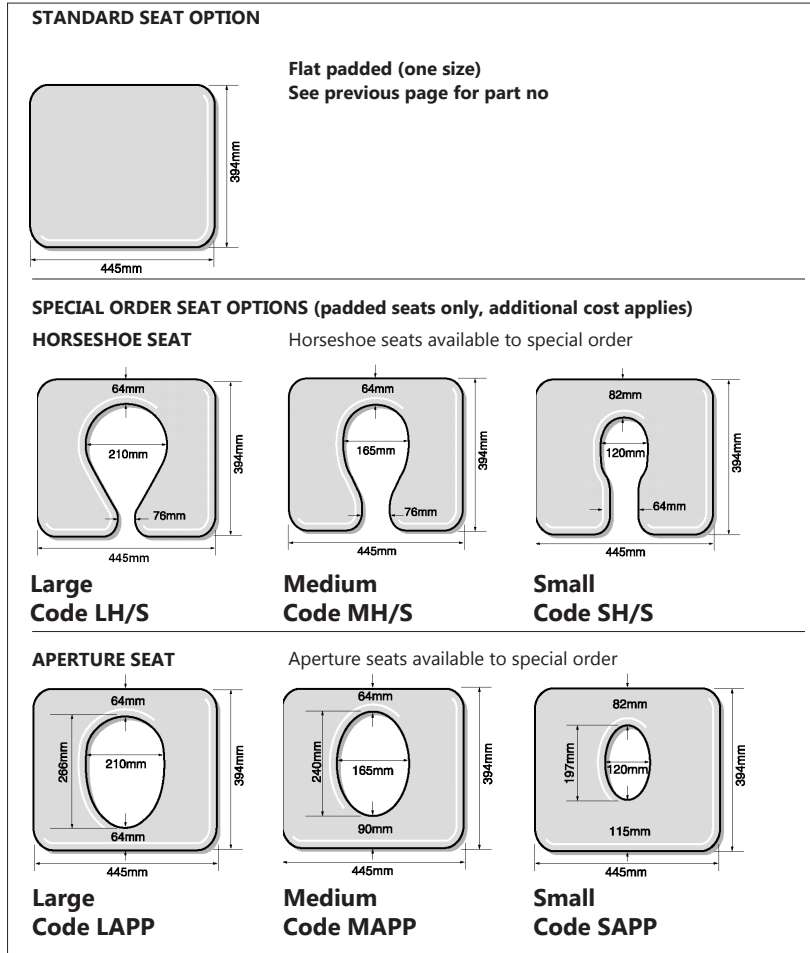



SHOWER TOILET CUBICLE RANGE

SHOWER CUBICLE SELECTOR

Use this shower tray selector to choose the cubicle base size required.

FRONT ENTRY 100MK2 SHOWER TOILET CUBICLE

Standard doors

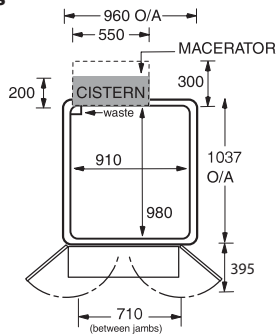

Ramp size
950mm Width x 280mm Depth

Bifold doors

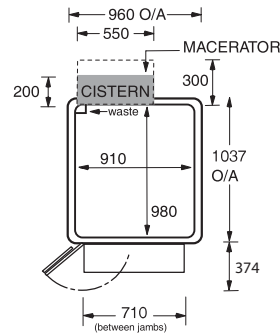

Note:
Left hand bifold illustrated. Right hand version available.

FRONT ENTRY SHOWER TOILET CUBICLE - 101

Standard doors

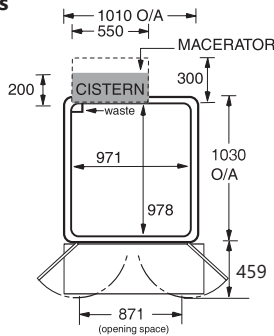

Ramp size
1010mm Width x 430mm Depth

Bifold doors

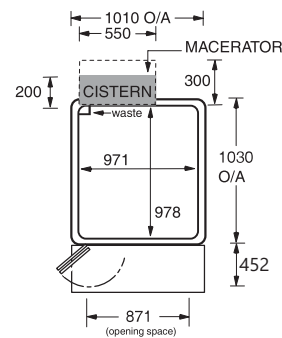

Note:
Left hand bifold illustrated. Right hand version available.

FRONT ENTRY SHOWER TOILET CUBICLE - 120PLUS

Standard doors

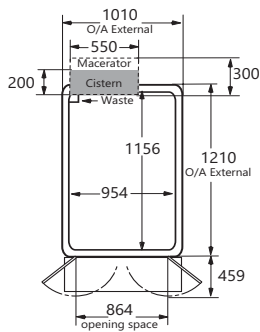

Ramp size
1010mm Width x 470mm Depth

Bifold doors

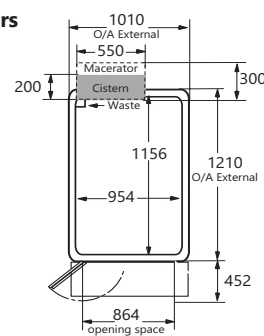

Note:
Left hand bifold illustrated. Right hand version available.

- Notes:**
1. Add 50mm at rear of cubicle to allow for waste hose - pumped waste
 2. Add 100mm to width to allow for shower unit services
 3. Allow as much space as possible to gain access to services for routine maintenance.

SHOWER CUBICLE SELECTOR - SHOWER CHAIR COMPATIBILITY



SHOWER CHAIR CUBICLE TOILET COMPATIBILITY



Cubicle Model	Shower Chair Model											
	A02	A06	A08	A11	A13	A20	A21	TA18AP	TA18SP	TA21AP	TA21SP	TIS
100	✓	✓	✓	✗	✗	✗	✗	✓	✗	✓	✗	✗
101	✓	✓	✓	✗	✗	✗	✗	✓	✗	✓	✗	✗
120Plus	✓	✓	✓	✓	✗	✗	✗	✓	✓	✓	✗	✓

* 21" Model - standard door option only

TIS model cannot be tilted when in the cubicle





HOW TO ORDER

Cubicle kit contents:

- White shower tray with ramp
- Full height enclosure pack (half height carer assist panels available on request)
- WC pan and cistern
- Plastic basin (fillable via shower hose)
- Door set - half height or bifold doors
- Curtain track, hooks & white shower curtain
- 2x Grab rails
- Fitting instructions

Extras

Ceramic basin & lever taps shown on p15
Shower unit shown on p15
Macerator shown on p16

	Option 1	Option 2	Option 3
Cubicle description	Half height door	Bifold (Left hand)	Bifold (Right hand)
101 Cubicle Toilet with pumped waste	Part no: SHTCU101PW		
101 Cubicle Toilet with gravity waste	Part no: SHTCU101G		

Technical information

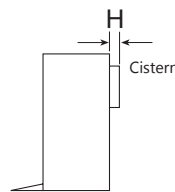
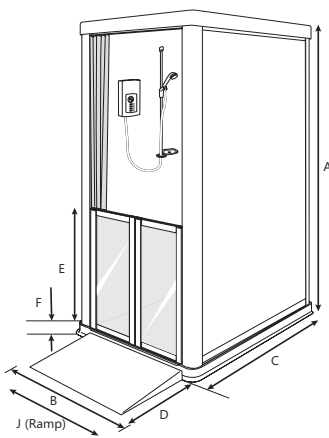

Ref	Dimensions
A	1900
B	1010*+
C	1030
D	430
E	810
F	50
H	200
J	1010

*Add 100mm if side controls fitted.
+Add 75mm if basin fitted.

Standard doors

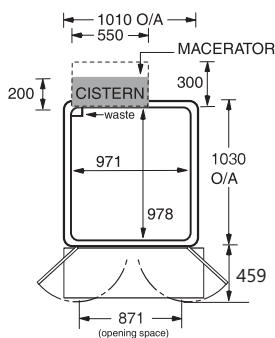

Bifold doors

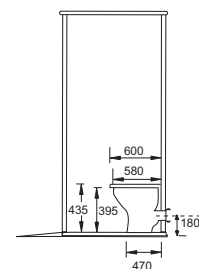
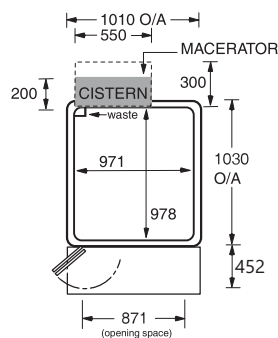

Note: centreline of waste is taken from top of cubicle base

Notes: Dimensions are for doors fully open.

Internal dimensions: The width is measured from acrylic panel to acrylic panel. The depth is taken from the back acrylic panel to the inner face of the door.



Shower chair compatibility

See page 10 for shower chair compatibility options





HOW TO ORDER

Cubicle kit contents:

- White shower tray with ramp
- Full height enclosure pack (half height carer assist panels available on request)
- WC pan and cistern
- Plastic basin (fillable via shower hose)
- Door set - half height or bifold doors
- Curtain track, hooks & white shower curtain
- 2x Grab rails
- Fitting instructions

Extras

Ceramic basin & lever taps shown on p15
Shower unit shown on p15
Macerator shown on p16

	Option 1	Option 2	Option 3
Cubicle description	Half height door	Bifold (Left hand)	Bifold (Right hand)
120Plus Cubicle Toilet with pumped waste	Part no: SHTCU120PWPLUS		
120Plus Cubicle Toilet with gravity waste	Part no: SHTCU120GPLUS		

Technical information

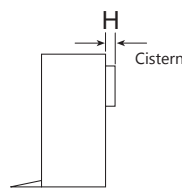
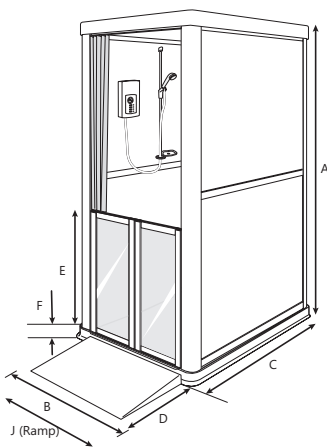

Ref	Dimensions
A	1900
B	1010
C	1215
D	470
E	810
F	50
H	200
J	1010

Notes:

*Add 100mm if side controls fitted.
+Add 75mm if basin fitted.

Standard doors

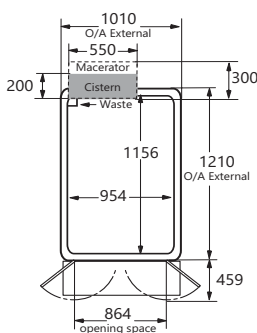

Bifold doors

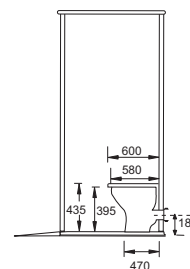
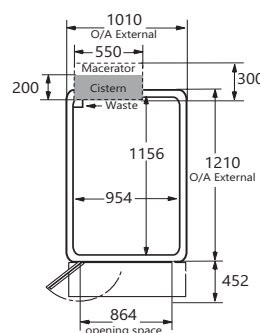

Note: centreline of waste is taken from top of cubicle base

Notes: Dimensions are for doors fully open.

Internal dimensions: The width is measured from acrylic panel to acrylic panel. The depth is taken from the back acrylic panel to the inner face of the door.



Shower chair compatibility

See page 10 for shower chair compatibility options



SANITARY SYSTEMS



SaniPRO XR Up small bore sanitary system

- Breaks down toilet waste from a shower, wash basin or W.C for pumping away through a small bore (22mm) pipe
- A powerful motor enables the unit to pump the waste and water up to 5m vertically, 100m horizontally or a lesser combination of both, where conventional large bore pipework is impractical
- Features a new case with sound reduction and integrated carbon filter to neutralise odours
- Easy maintenance with access hatch to basket without dismantling device or emptying tank

code	product
SH0412	Sanipro XR Up sanitary system

Technical information

- Motor induction motor (no carbon brushes or gears to wear out). Tested over 30,000 cycles.
- Watts (Consumption) 400w
- Electrical Supply 220-240V 50Hz
- Flow rate at max head l/min 50 Horizontal Discharge 100 metres
- Vertical Discharge 5 metres
- Gravity fall on horizontal installations 1:100
- Discharge Pipe Diameter 22/28/32mm
- Normal Running Time WC 10–20 secs approx or as required, to discharge bath, shower etc

Designed to fit BS EN 33/37 WC pans.

As close coupled cistern dimensions vary, it may be necessary, with certain designs, to utilise a spacer between cistern and wall

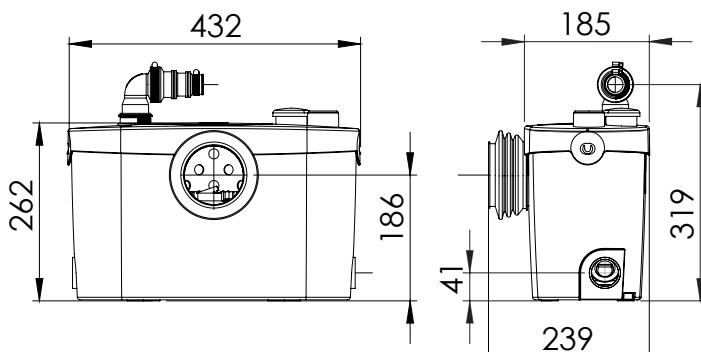

Pumping distance illustration

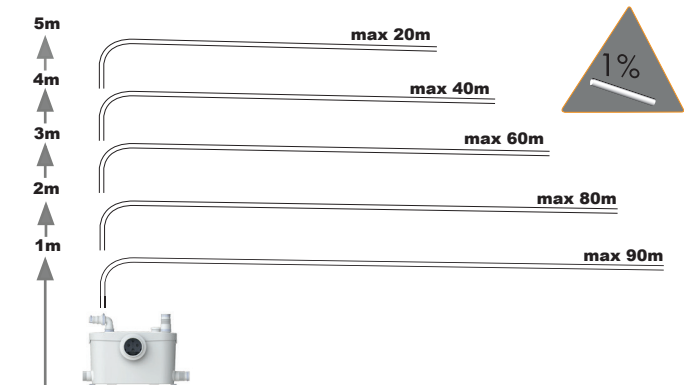

Macerator shown in relation to a Chiltern Invadex Shower toilet cubicle

